

# Cypress Pointe

7445 Ship Builders Drive, Seaford, DE 19973



These new homes in Seaford, DE, are located amidst tall trees and fertile farmland. Cypress Pointe offers residents the charm of a country neighborhood located conveniently close to town. Seaford is popular for its great location just minutes from Seaford, Laurel, Salisbury and more. It also offers plenty of opportunities for kayaking, fishing, bird-watching, and much more.

Cypress Pointe is the perfect place to find your new home in Seaford. Streetlights make it a great place to walk, run, or bike anytime. Choice lots back up to woods or ponds. Contact us to reserve yours today!

We do not have a model home at Cypress Pointe, but you're welcome to visit and get to know the neighborhood! We do have a decorated model nearby at Hawthorne.

**From Route 13 (heading South from Seaford):** Turn right onto Camp Road (turns into Bethel Road). Turn right onto Woodland Ferry Road. The community is on your left (Ship Builder Drive).



[sales@insightde.com](mailto:sales@insightde.com)  
302-956-9337



Features, homes and pricing are subject to change without previous notice. Home designs are artist renderings and some homes offered may have design differences.

Prices good through 5/15/2026

[www.itsjustabetterhouse.com](http://www.itsjustabetterhouse.com)



# Cypress Pointe

7445 Ship Builders Drive, Seaford, DE 19973



## Lloyd

**\$450,900**

1,712 - 2,760 Sq. Ft.  
3 - 5 BR | 2 - 3 BA | 1 or 2 STORY



## Whatley

**\$471,900**

1,979 - 3,590 Sq. Ft.  
3 - 6 BR | 2 - 4 BA | 1 or 2 STORY



## Brenner

**\$477,900**

1,975 - 2,489 Sq. Ft.  
3 - 4 BR | 2.5 - 3.5 BA | 2 STORY



## Jerry

**\$496,900**

2,140 - 3,401 Sq. Ft.  
3 - 6 BR | 2 - 3.5 BA | 1 or 2 STORY



## Frank

**\$500,900**

2,572 - 3,010 Sq. Ft.  
4 - 5 BR | 3 BA | 2 STORY



## Peterman II

**\$578,100**

3,145 - 3,735 Sq. Ft.  
4 - 6 BR | 3 - 4 BA | 2 STORY



## Cartwright

**\$466,900**

1,821 - 3,817 Sq. Ft.  
3 - 5 BR | 2 - 3.5 BA | 1 or 2 STORY



## Drake

**\$475,900**

1,918 - 2,536 Sq. Ft.  
4 BR | 2 BA | 1 STORY



## Elaine

**\$480,900**

2,181 - 2,603 Sq. Ft.  
3 - 4 BR | 2 - 2.5 BA | 1 STORY



## Nelson

**\$498,900**

2,405 - 3,941 Sq. Ft.  
3 - 5 BR | 2 - 3.5 BA | 1 or 2 STORY



## Reston

**\$554,100**

2,484 - 3,266 Sq. Ft.  
3 - 6 BR | 2.5 - 3.5 BA | 2 STORY



## Kramer

**\$607,100**

3,167 - 4,277 Sq. Ft.  
3 - 6 BR | 2.5 - 4 BA | 2 STORY

sales@insightde.com  
302-956-9337

**Insight Homes**  
It's Just a Better House

Features, homes and pricing are subject to change without previous notice. Home designs are artist renderings and some homes offered may have design differences.

Prices good through 5/15/2026

[www.itsjustabetterhouse.com](http://www.itsjustabetterhouse.com)



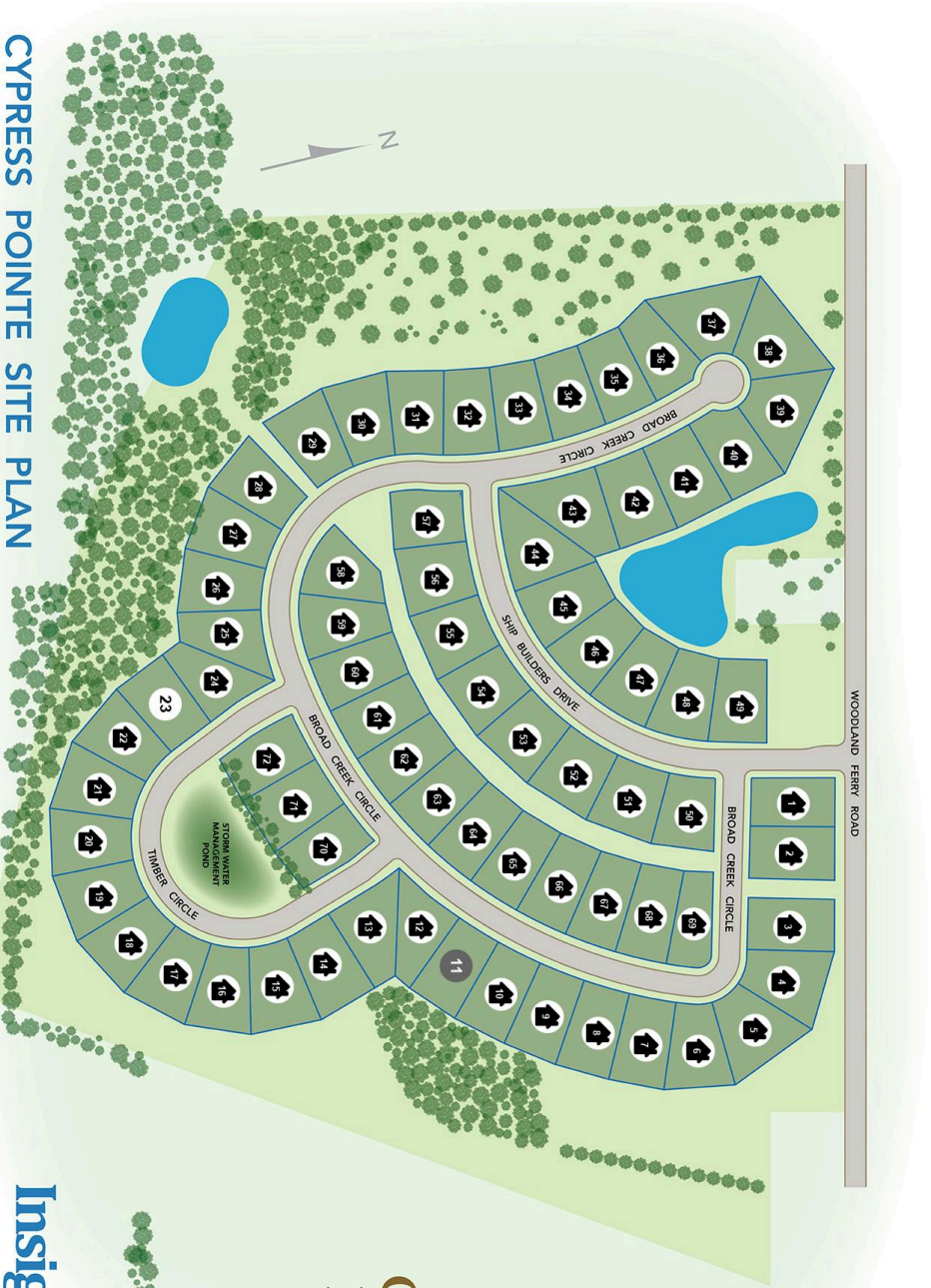

WOODLAND FERRY ROAD

- ★ FURNISHED MODEL HOME
- AVAILABLE LOTS
- NOT AVAILABLE
- SOLD LOTS
- 🏠 COMPLETED HOME
- MOVE-IN READY HOME

# CYPRESS POINTE



## CYPRESS POINTE SITE PLAN

All site plans, community maps and computer generated or enhanced depictions shown are conceptual in nature, which may not accurately represent the actual condition of the item(s) being represented and are subject to change without notice. All buying decisions should be based on visiting and viewing the physical homesite.